



BARDI ORCHESTRA VISIT TO HTL

Covid-Secure Arrangements

Winds/Horns/Brass

Arrive 10.45am, play 11am-1pm

Strings

Arrive 2.15pm, play 2.30-4.30pm

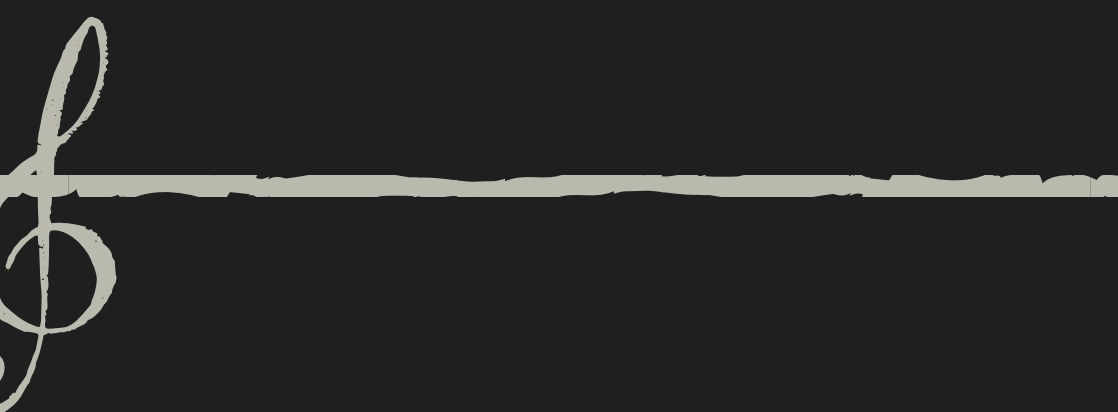

Holy Trinity (HTL) is looking forward to welcoming you back to our premises for another day of playing together.

We have taken several steps to become a Covid-Secure facility and have been successfully running public worship services and youth groups with heightened safety measures in Autumn 2020 and since.

We hope this document gives you a clear understanding of what you can expect on the day and what we are asking of you.

General Requirements

We first ask that if you are experiencing symptoms, then you do not attend. Instead you stay (or return) home to commence self-isolation and book in a coronavirus test online at <https://self-referral.test-for-coronavirus.service.gov.uk/antigen/name> or by calling 119. The symptoms are:

- A new, continuous cough
- A high temperature
- A change to your sense of taste or smell.

If you begin to experience symptoms when you are here, please help others be safe by putting on a face covering immediately, limiting your interactions with others and going home to commence self isolation and order yourself a test. You should not attend if you are shielding and have not had a vaccine.

Mingling is permitted in groups of up to 6 or two households. Please don't change groups though. Otherwise please maintain 2m distance between yourself and anyone not in your household or support bubble.

Please catch your cough or sneeze in either a tissue (which should then be thrown away) or a sleeve/handkerchief (where a tissue is unavailable). Keep high levels of personal hygiene - wash hands regularly with soap or use hand sanitizer.

If you can, avoid public transport. Walk, drive by yourself or cycle in.

Please avoid raised voices.

Please respect the staff on duty - they are here for your safety.



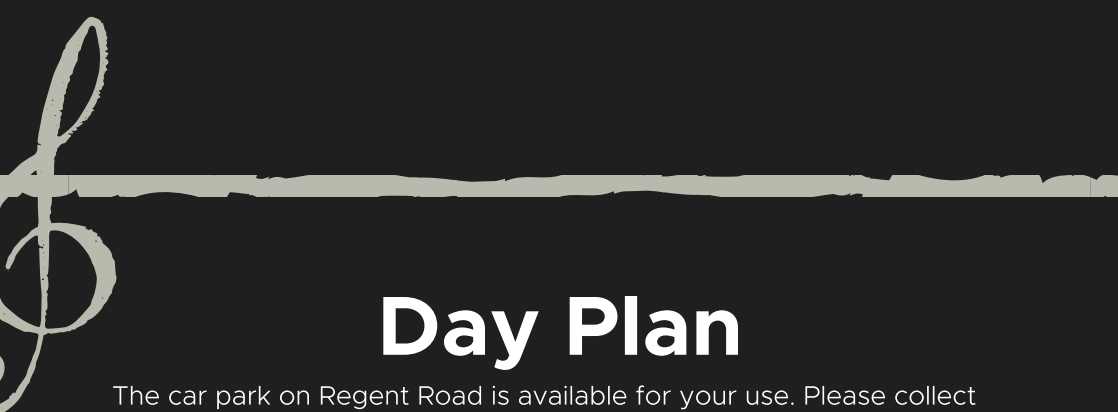

Day Plan

The car park on Regent Road is available for your use. Please collect a permit from the steward on duty and place face up on your car dashboard. At the end of the day you can recycle this.

There are two sessions during the day and you will be aware of that which you are to attend.

Please arrive at the front door of HTL 15 minutes before your session is due to begin and on arrival use hand sanitizer. This allows us time to ensure we have registered your details for NHS Test and Trace. In the event of bad weather, you will be able to wait in the foyer of the church. You can register your attendance in advance by using the link www.htl.church/Register.

Please wear a face covering when you are not sat at your position in the main hall. This includes entering, walking about, using the toilet and departing.

Each session is 2 hours long but with flexibility for breaks and a little overrun.

Toilets are available if needed, but please try to avoid it if possible. The HTL team will clean toilet facilities between groups. Numbers in toilets will be limited to allow for social distancing - please respect the instructions given.

Prior to the end of each session, the HTL team will clean all frequent touch points (e.g. door handles, taps, etc.) with an approved anti-virucidal cleaning agent. The next group to arrive will therefore enter a clean environment.

The Lounge available for instrument cases and coats - please ensure you keep your possessions at least 2m away from the next person.

We will not be able to provide refreshments - please bring your own drink if you need one.

During rehearsal time, we will keep a fire escape and windows open in the main hall to aid natural ventilation. This may cause a slight chill so please come prepared. It will inevitably cause additional noise from the main road but unfortunately we cannot help this. During recording we will close the door to limit external noise.

At the end of your session, please follow the directions for departing.

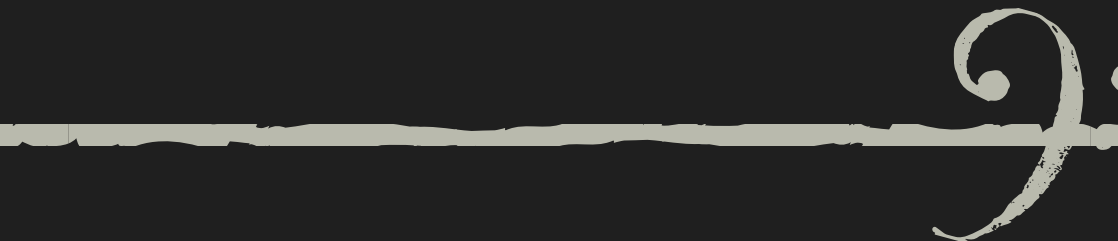



Covid-Secure Protocols

HTL has implemented the following measures to ensure our facility is Covid-secure, including carrying out a building risk assessment and generating a list of controls/protocols to follow as a result.

The following protocols will be followed during your visit:

- 1.No person experiencing symptoms will be permitted access. Instead they should return home to commence self-isolation and book in a coronavirus test online at <https://self-referral.test-for-coronavirus.service.gov.uk/antigen/name> or by calling 119.
- 2.On arrival, names and contact telephone numbers will be taken for the purposes of supporting the NHS Test and Trace system.
- 3.Social distancing of 2m will be maintained at all times, except where there is a legitimate need for a 1m distance with appropriate risk mitigation (e.g. a face covering) in place.
- 4.High levels of personal hygiene will be encouraged, e.g. visitors will be asked to sanitize or thoroughly wash their hands on arrival.
- 5.Higher levels of cleaning will be in operation.

The HTL team use "Evans Safe Zone Plus" virucidal disinfectant agent for cleaning between groups. We apply this to surfaces where there is the potential for frequent touch by multiple people, e.g. door handles, taps, toilet flush buttons and chair frames.

We are limiting the number of shared items.

Hand sanitizer dispensers are available throughout the building.

HTL Floor Plan

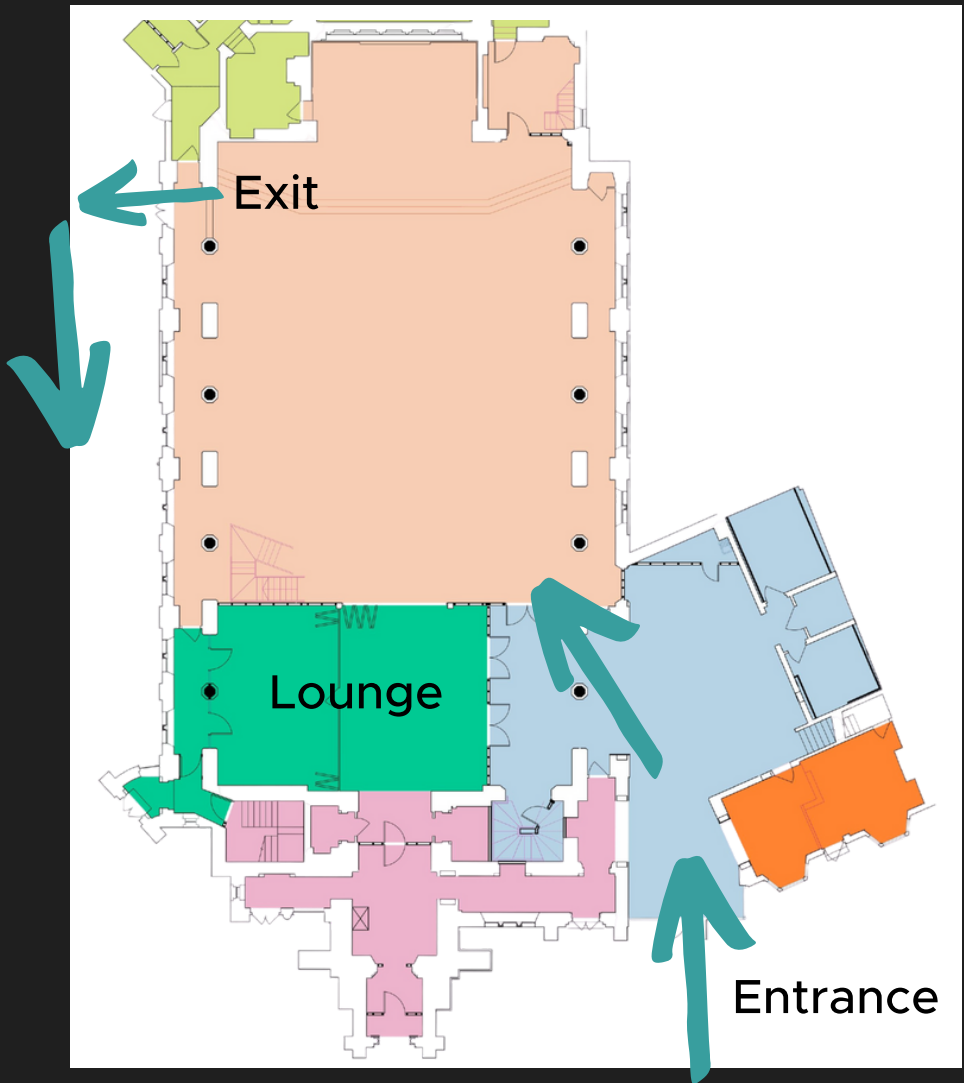

htl church

